

8

7

6

5

4

3

2

1

REVISIONS

EFFECTIVITY	REV	DESCRIPTION	DATE	APPROVED
FUTURE	A	FIRST RELEASE ISSUE	8 / 20 / 04	

NOTES:

1. MOTOR ASSEMBLY SHOWN WITH OVERALL EXTERIOR DIMENSIONS.

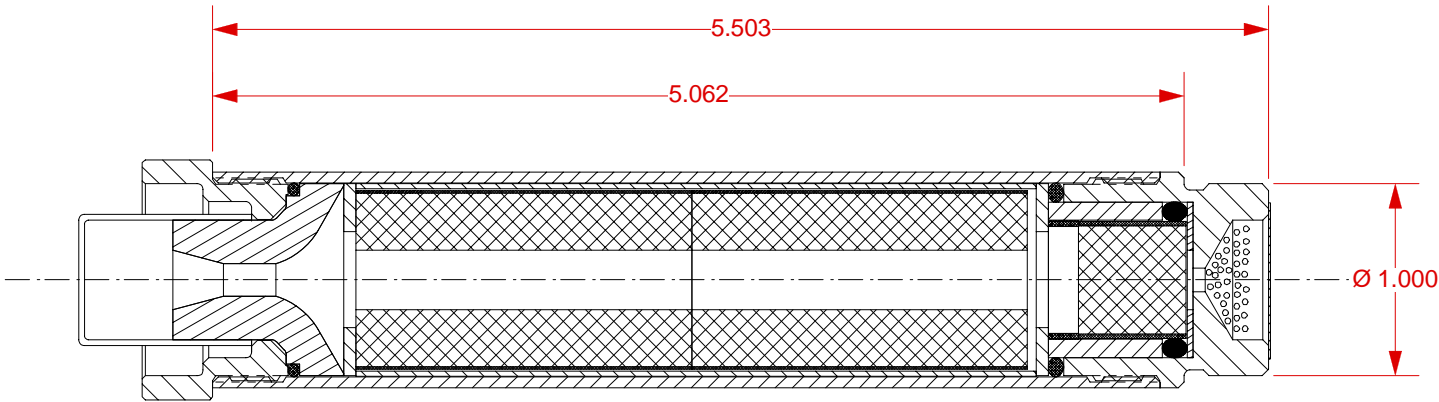

0.368

Ø 1.250

Ø 1.125

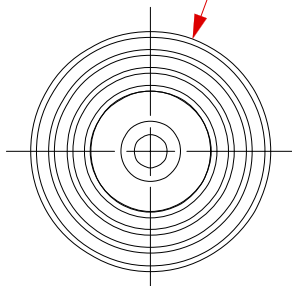

VIEW AFT CLOSURE

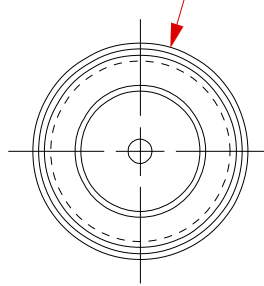

VIEW FORWARD CLOSURE

SUPPLIER DATA

RELOAD KIT IDENTIFICATION

UNLESS OTHERWISE SPECIFIED DIMENSIONS ARE IN INCHES

AEROTECH

.XX +/- .010	.XXX +/- .005	ANGLES +/- 2 deg.
-----------------	------------------	----------------------

MATERIAL

NOTED

FINISH

QTY	PART NUMBER	DESCRIPTION	ITEM
-----	-------------	-------------	------

LIST OF MATERIAL

CONTRACT NUMBER

RCS ROCKET MOTOR COMPONENTS, INC.
 2113 W. 850 N. Street
 Cedar City, Utah 84720
 (435) 865-7100 (Ph)
 (435) 865-7120 (Fax)

PREP	B. ROSENFELD	8 / 04
CHKR		

HP 29/120 MOTOR DIMENSIONAL DRAWING

APVD	
APVD	

SIZE	NUMBER
A	ASSY DWG

PART NUMBER

DESCRIPTION

SCALE 1 / 1

SHEET 1 OF 1

8

7

6

5

4

3

2

1